

NOGVA GEAR HC-258

> 37,7 HP @ 100 RPM (3.03:1)

- > Servo for CPP
- > Optional with 1 or 2 PTO's
- > Propeller shaft break built in
- > Hydraulic multiplate clutch
- > Controlled in test bench
- > More than 3000 gearboxes on the market

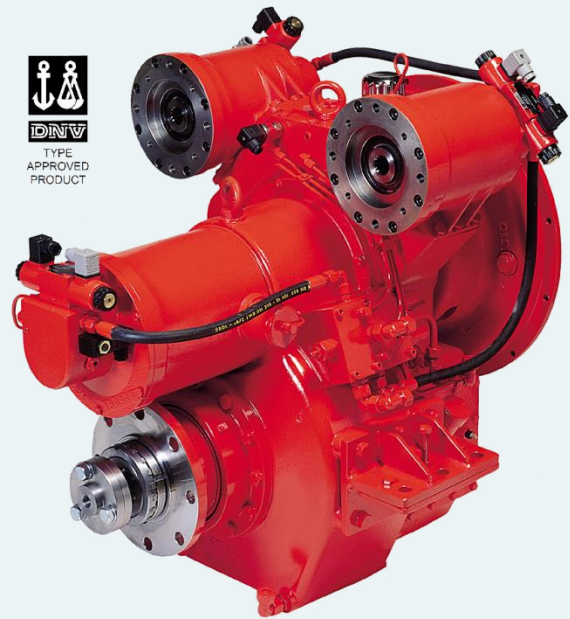

Nogva Gearbox HC-258

Built-in servo for CPP. Construction in rigid cast iron house, helical gearwheels, conical roller bearings and hydraulic multiplate clutch. Individually controlled in test bench.

Technical specifications	
Connection flange	SAE 1
Flexible coupling	SAE 14"
Weight with 1 PTO	620 kg (SAE 1)
Weight with 2 PTO	660 kg (SAE 1)
Servo force	83 000 N
Servo stroke	85 mm
Rotation (outgoing shaft)	Clockwise*
Maximum torque	
Reduction	Torque
2.02:1	3180 Nm
2.51:1	2650 Nm
3.03:1	2650 Nm
3.54:1	2390 Nm
3.95:1	1960 Nm
4.45:1	1760 Nm
Power take off (PTO)	
Ratio	1:1.16
Torque	955 Nm
Max power	150 kW
Flange	SAE C 12/24 DP (standard)
Pump rotation	Clockwise

Performance curve

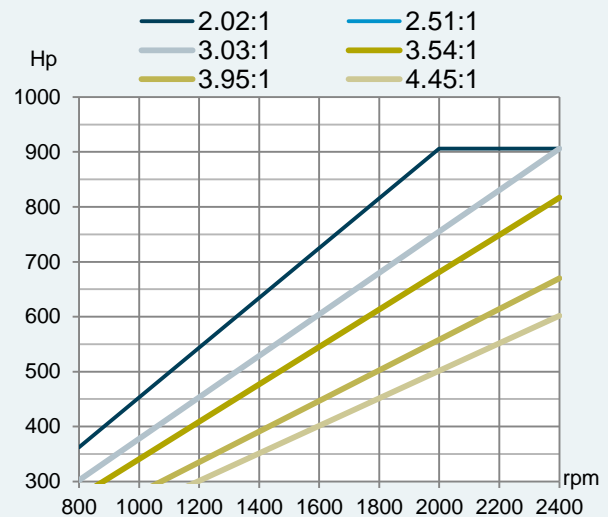

Performance curve

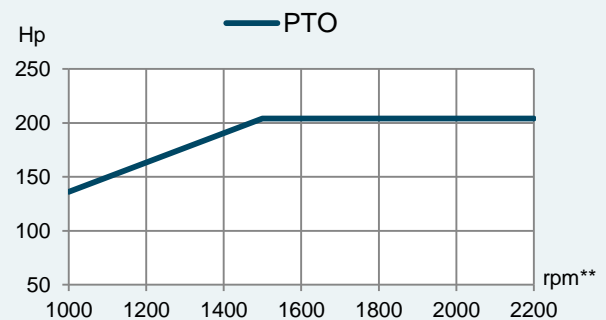

**rpm on PTO

NOGVA GEAR HC-258

Standard equipment

- > Oil pump
- > Oil cooler
- > Oil filter
- > Flexible coupling

Optional equipment

- > Nogva CPP
- > HC-gear control
- > Monitoring (oil temperature/pressure)

Dimensions

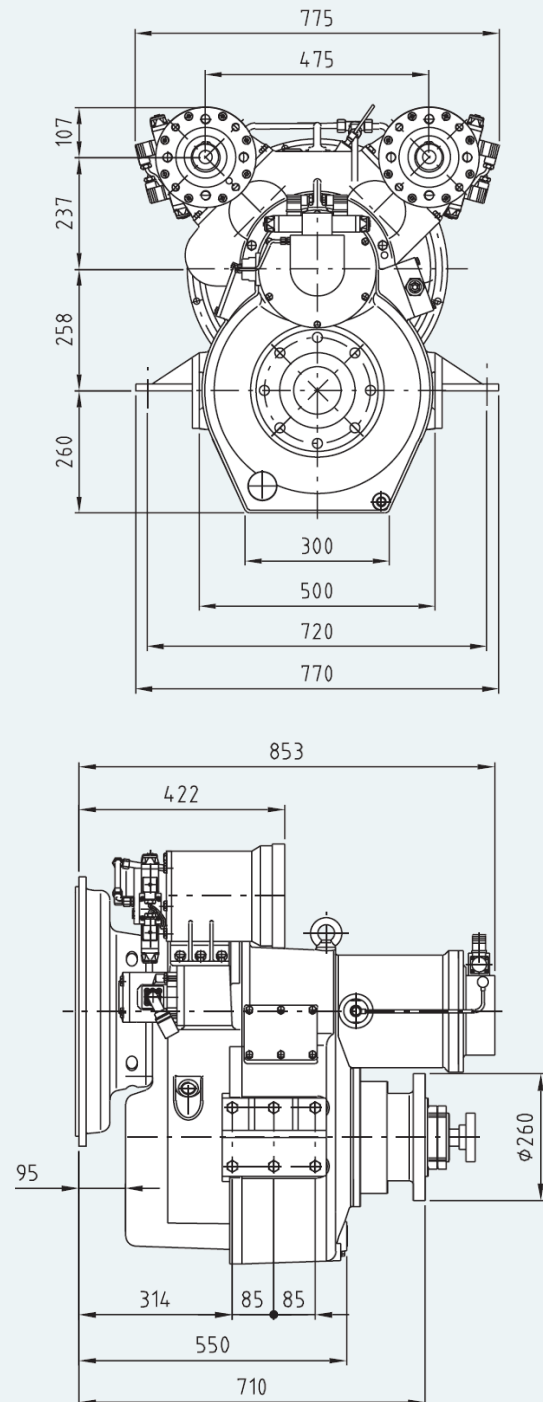

* SAE 1 and SAE 2